

4. Disassembly and Reassembly

4-1 Replacement of Magnetron, Motor Assembly and Lamp

Remove the magnetron including the shield case, permanent magnet, choke coils and capacitors (all of which are contained in one assembly).

1. Disconnect all lead wires from the magnetron.
2. Remove a screw securing air cover.
3. Remove the air cover.
4. Remove screws securing the magnetron to the wave guide.
5. Take out the magnetron very carefully.
6. Remove a screw securing Bracket MGT.
7. Remove the Bracket MGT.

NOTE1: When removing the magnetron, make sure that its antenna does not hit any adjacent parts, or it may be damaged.

NOTE2: When replacing the magnetron, be sure to remount the magnetron gasket in the correct position and make sure the gasket is in good condition.

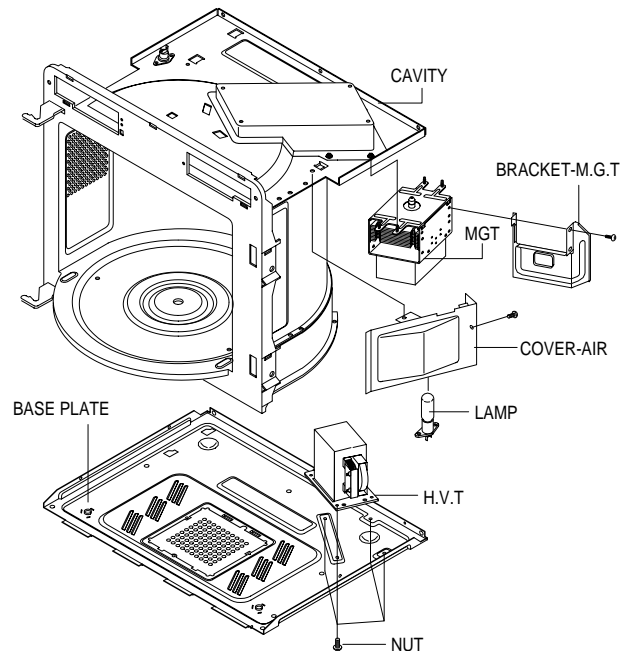

4-2 Replacement of High Voltage Capacitor

1. Discharge the high voltage capacitor.
2. Disconnect all the leads.
3. Remove the screw.
4. Reconnect the leads correctly and firmly.

PRECAUTION

Servicemen should remove their watches whenever working close to or replacing the magnetron.

PRECAUTION

There exists HIGH VOLTAGE ELECTRICITY with high current capabilities in the circuits of the HIGH VOLTAGE TRANSFORMER secondary and filament terminals. It is extremely dangerous to work on or near these circuits with the oven energized. DO NOT measure the voltage in the high voltage circuit including filament voltage of magnetron.

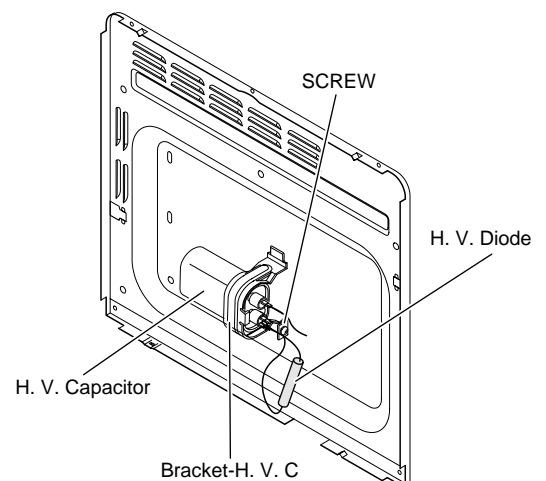

4-3 Replacement of Control Circuit Board

4-3-1 Removal of Control Box Assembly

1. Remove the screws securing the out panel and take out the out panel.
2. Disconnect all lead wires from the control box.
3. Remove screws securing the rear of the control box.
4. Push the control box to left side then take out the control box.

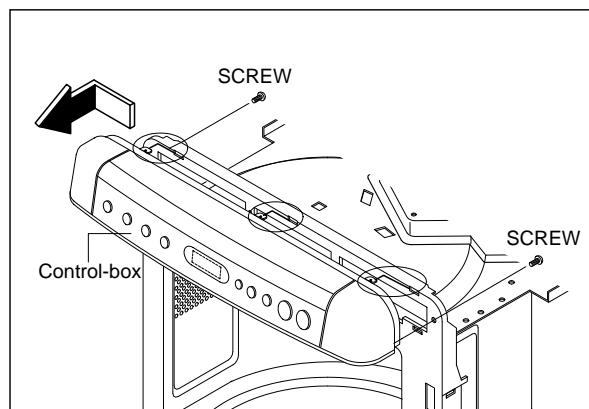

4-3-2 Removal of Main P.C.B Assembly

1. Disconnect all lead wires from the Main P.C.B.
2. Remove screws securing and plastic fasteners of the Main P.C.B.

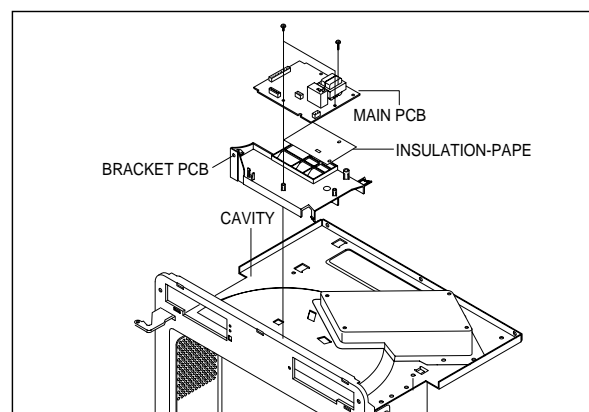

4-3-3 Removal of Sub P.C.B Assembly

1. Disconnect all lead wires from the Sub P.C.B.
2. Remove screws securing of the Sub P.C.B..

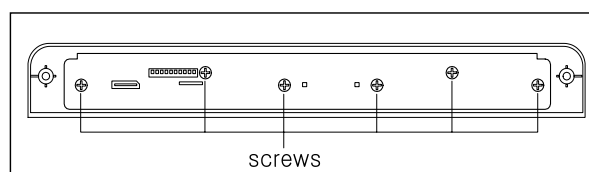

4-4 Replacement of Fuse

1. Disconnect the oven from the power source.
2. When 12A fuse blows out by the operation of interlock monitor switch failure, replace the primary interlock switch, door sensing switch, monitor switch and power relay.
3. When the above three switches operate properly, check if any other part such as the control circuit board, blower motor or high voltage transformer is defective.

4-5 Replacement of Drive Motor

1. Take out the glass tray, guide roller from cavity.
2. Turn the oven upside down to replace the drive motor.
3. Remove a screw securing the drive motor cover or disconnect the drive motor cover from base plate by nipper.
4. Disconnect all the lead wires from the drive motor.
5. Remove screws securing the drive motor to the cavity.
6. Remove the drive motor and the coupler.
7. When replacing the drive motor, be sure to remount it in the correct position with the coupler.
8. Connect all the leads to the drive motor.
9. Screw the drive motor cover to the base plate with a screw driver.

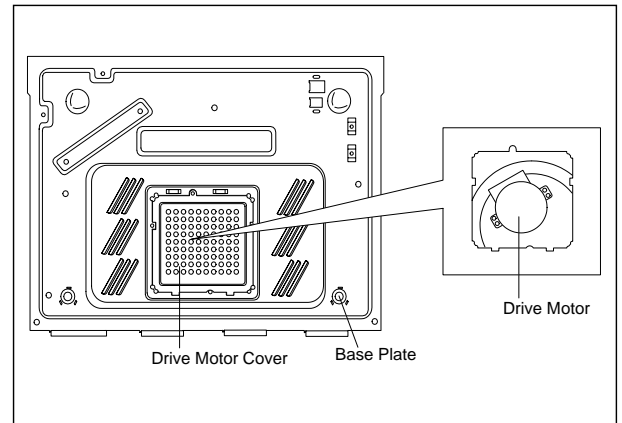

4-6 Replacement of Door Assembly

4-6-1 Removal of Door "C"

1. Remove the control box.
2. Insert the thin metal plate(0.5mm or less) between door-a and door-c then take out the door-c very carefully.

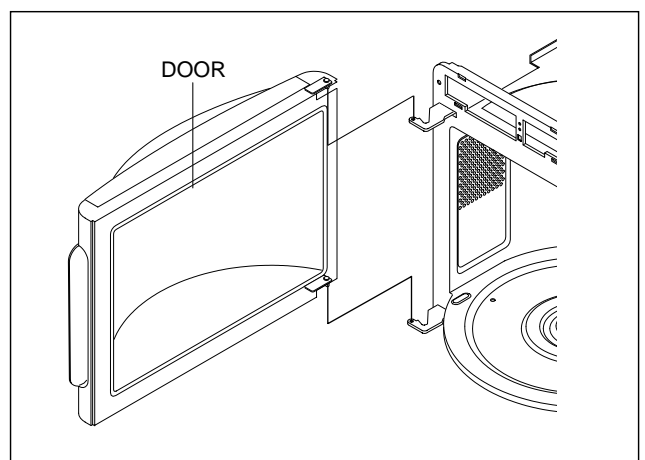
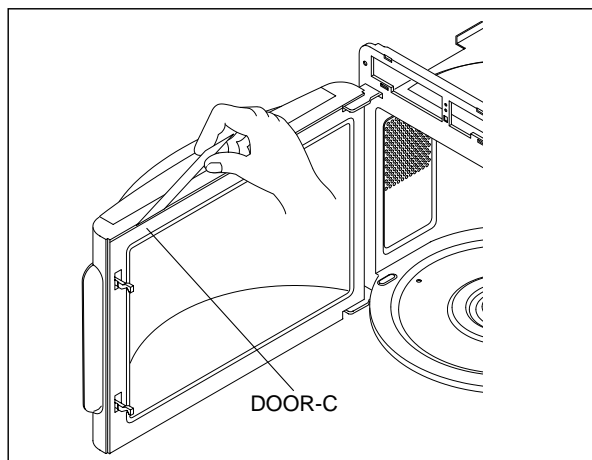

4-6-2 Removal of Door "E"

1. Following the procedure as shown in the figure, insert and bend a thin metal plate between Door "E" and Door "A" until you hear the 'tick' sound.
2. Insertion depth of the thin metal plate should be 0.5mm or less.

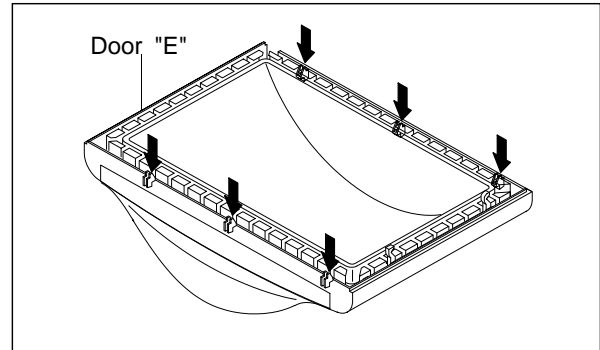

4-6-3 Removal of Screen Door and Door A

1. Remove the screw securing Door A and Screen Door

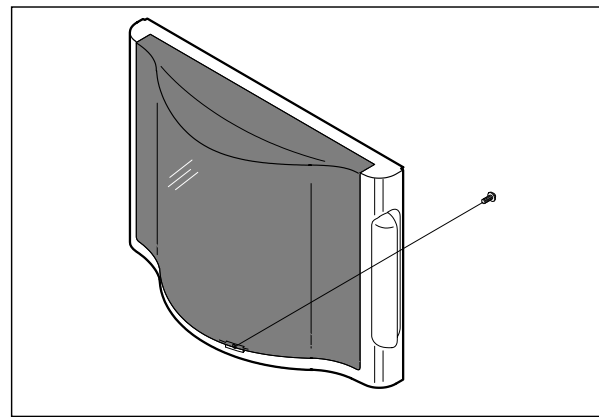

4-6-4 Removal of Key Door & Spring

1. Push up key door, take out key door from Door "E" Door "E" slot.
2. Take out spring.

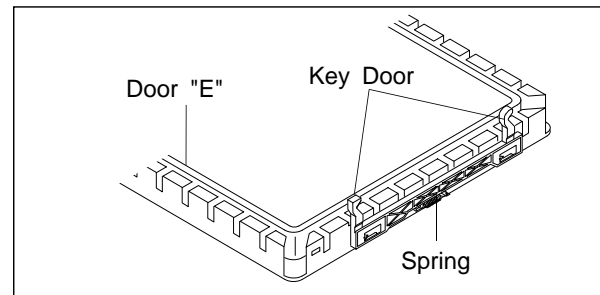

4-6-5 Reassembly Test

After replacement of the defective component parts of the door, reassemble it and follow the instructions below for proper installation and adjustment so as to prevent an excessive microwave leakage.

1. When mounting the door to the oven, be sure to adjust the door parallel to the bottom line of the oven face plate by moving the upper hinge and lower hinge in the direction necessary for proper alignment.
2. Adjust so that the door has no play between the inner door surface and oven front surface. If the door assembly is not mounted properly, microwave energy may leak from the space between the door and oven.
3. Do the microwave leakage test.